

REVISION HISTORY			
REVISION	CHANGE	DATE	APPROVED
A		06/12/2023	Frank Stanton

! RETURN LINE PRESSURE MUST EXCEED CASE DRAIN PRESSURE AT ALL TIMES

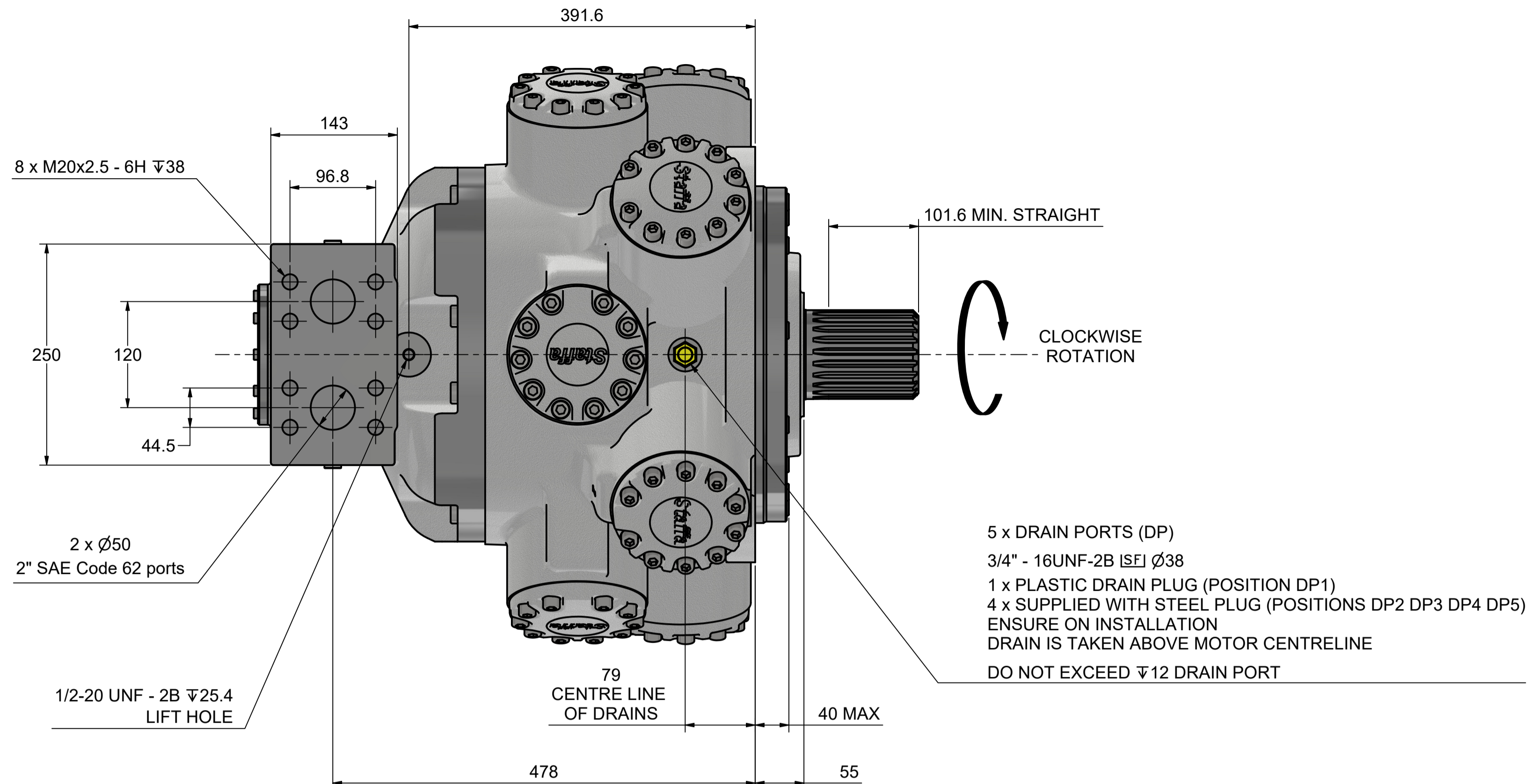
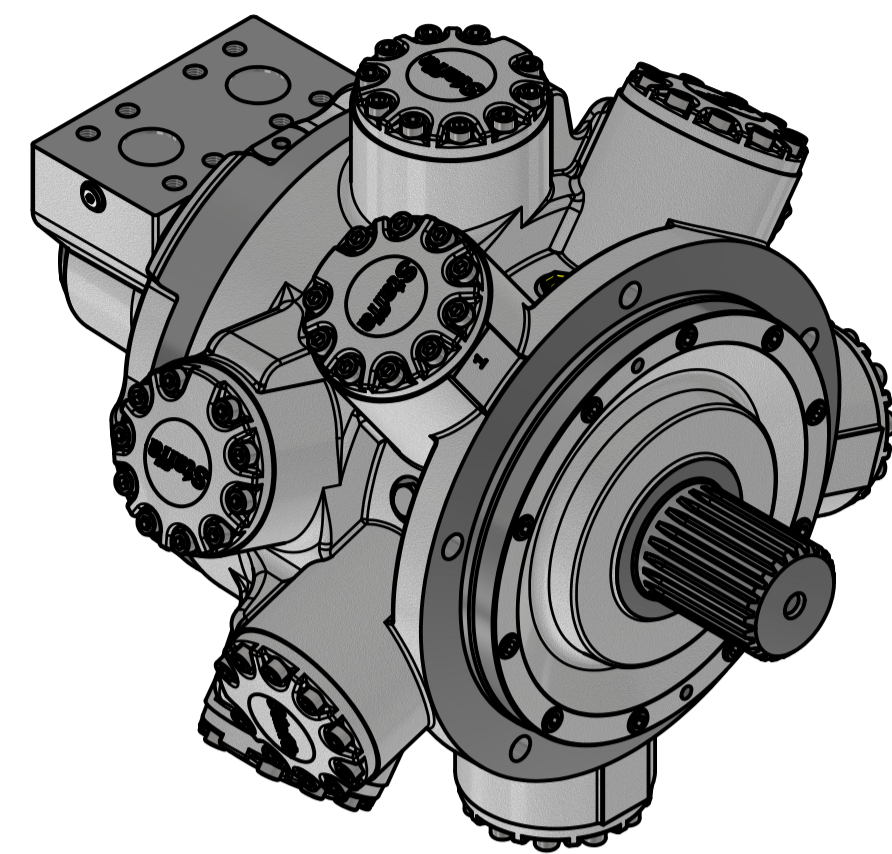

BS 3550 (ANSI B92.1, CLASS 5) FLAT ROOT SIDE FIT, CALSS 1	
PRESSURE ANGLE	30
NUMBER OF TEETH	23
PITCH	6/12
MAJOR DIAMETER	100.653 / 100.526
FORM DIAMETER	92.939
MINOR DIAMETER	92.184 / 91.625
PIN DIAMETER	8.128
DIAMETER OVER PINS	109.573 / 109.517

REVERSE PORT CONNECTIONS FOR OPPOSITE DIRECTION OF SHAFT ROTATION

FLOW DIRECTION

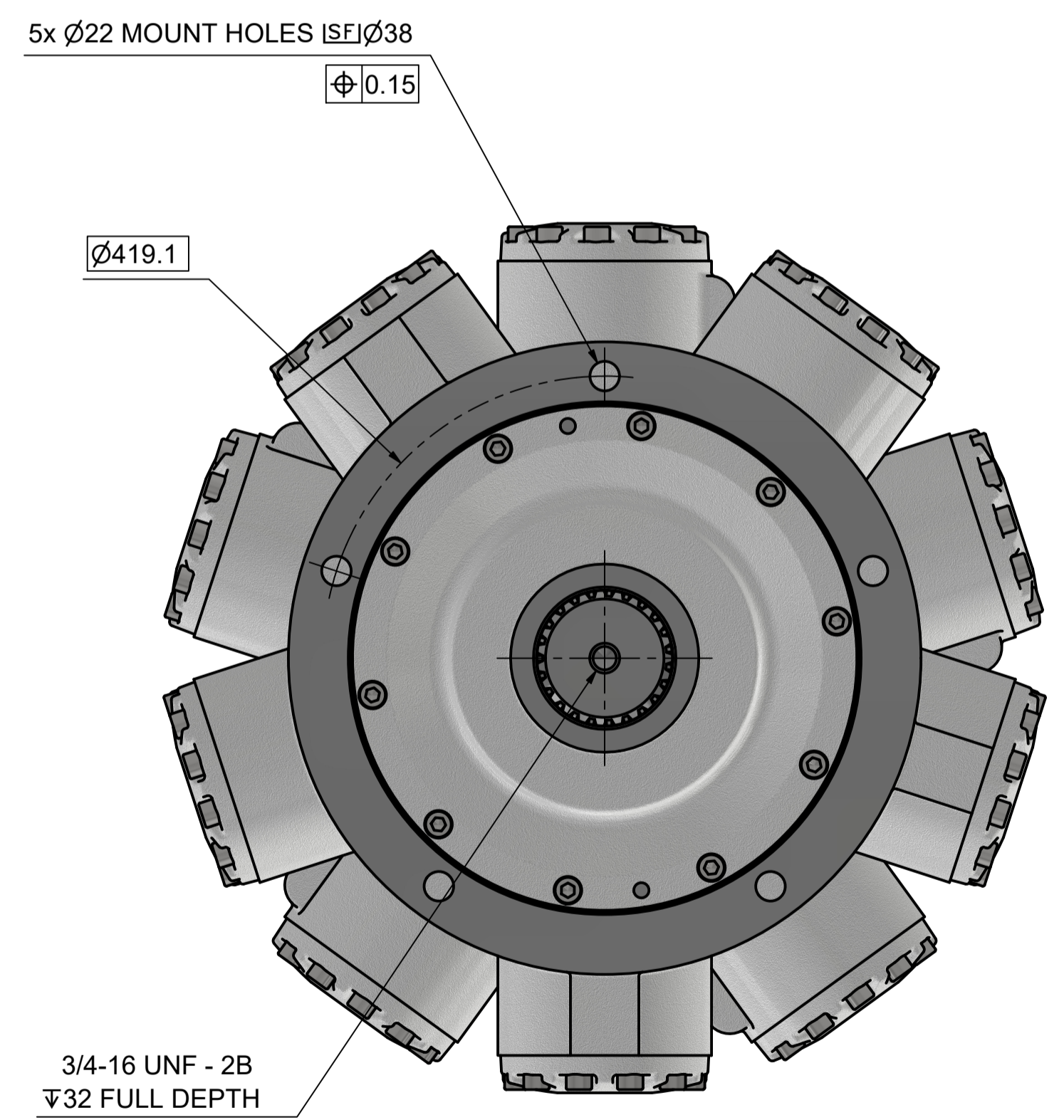
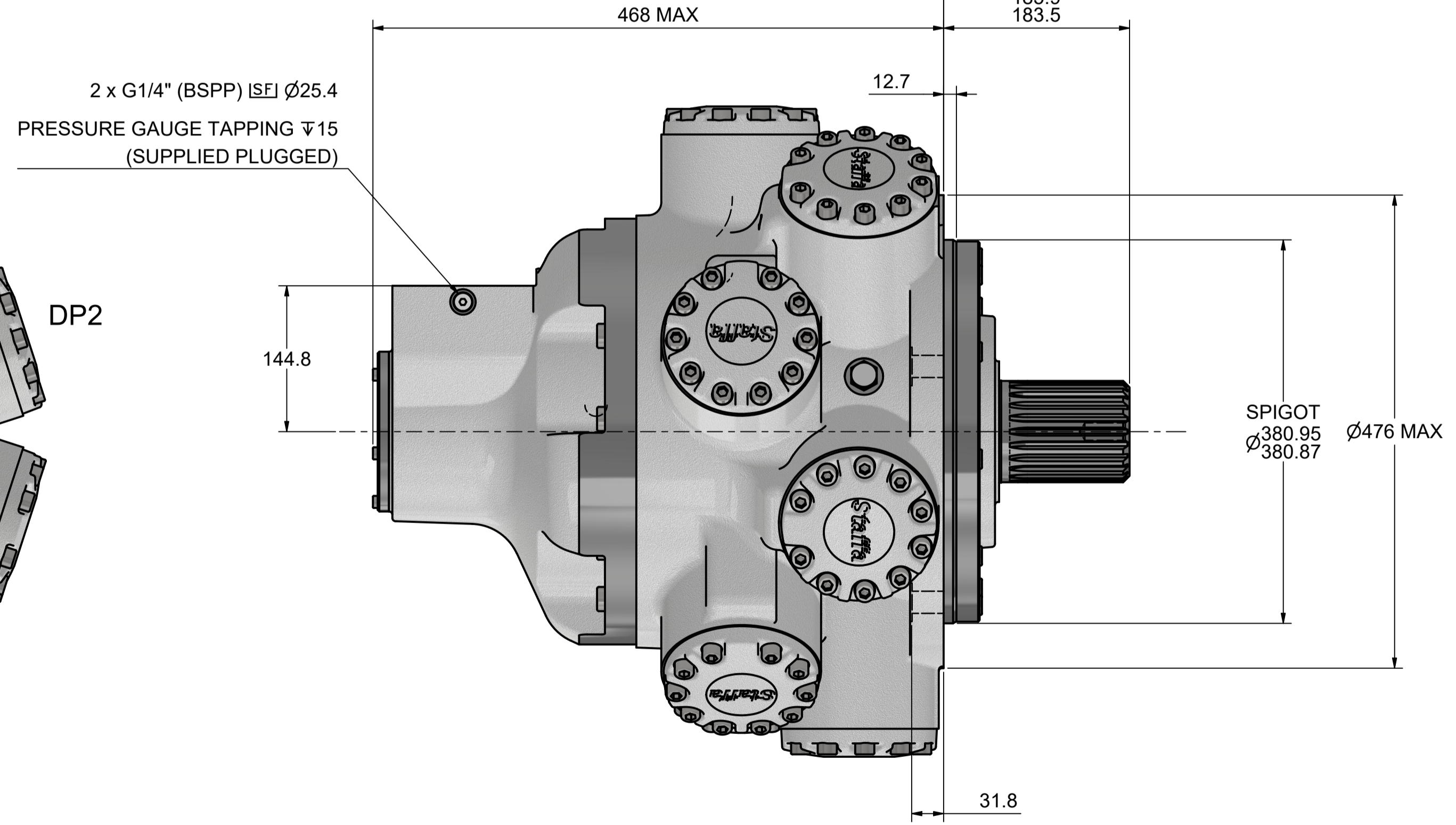
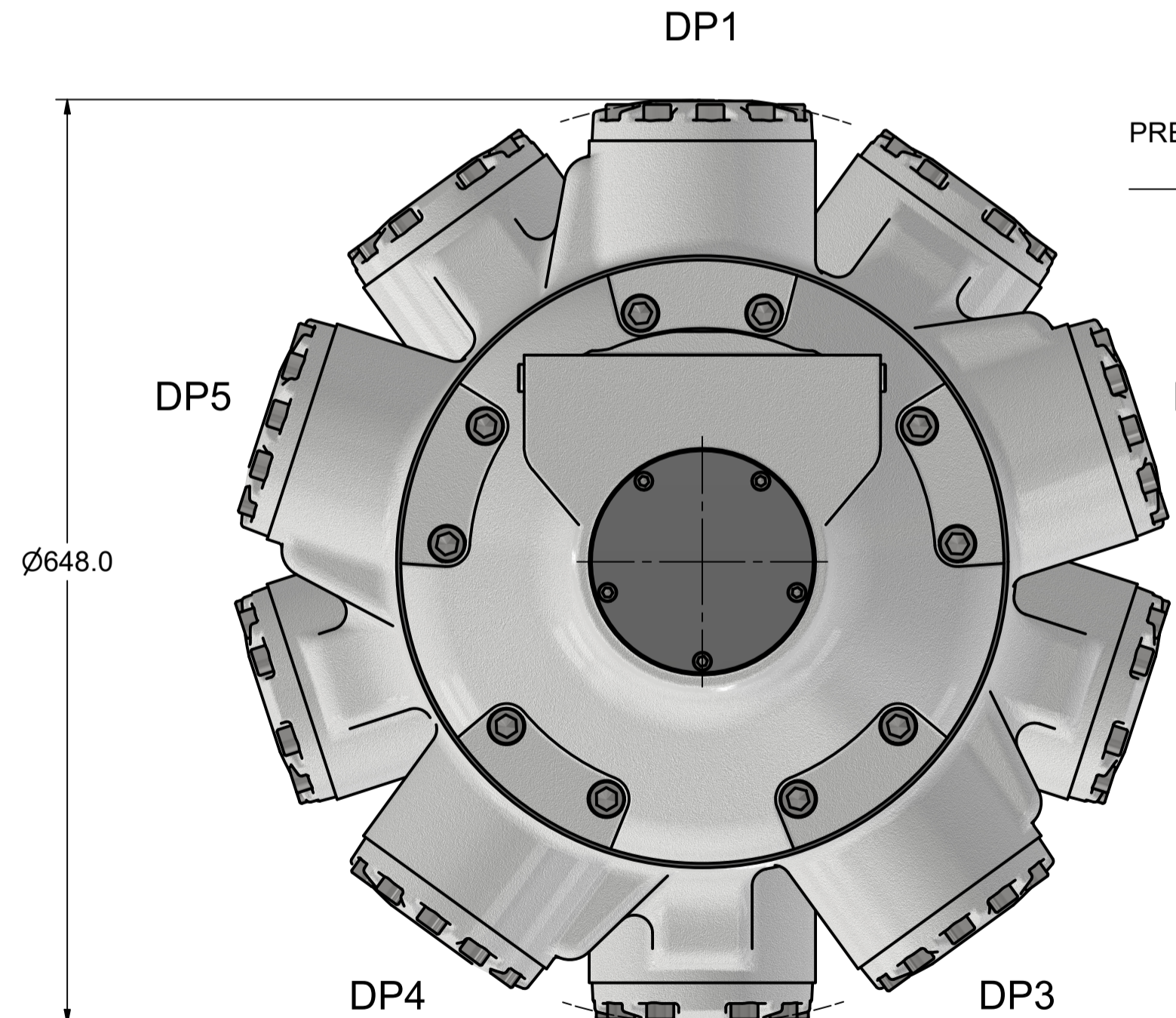

DISPLACEMENT	cc/rev	6800
SPECIFIC RUNNING TORQUE	Nm/bar	101
MAX CONTINUOUS SPEED	RPM	120
MAX CONTINUOUS POWER	kW	190
MAX CONTINUOUS PRESSURE	bar	250
MAX INTERMITTENT PRESSURE	bar	300
APPROXIMATE MASS	kg	530

ALL TECHNICAL DATA DISCLOSED HEREIN IS THE PROPERTY OF KAWASAKI AND SHALL NOT BE USED BY OTHERS FOR MANUFACTURE, PROCUREMENT OR DISCLOSURE WITHOUT THE WRITTEN PERMISSION OF THE OWNER.

DESIGN	NAME	DATE	
CHKD	Christian Callanga	06/12/2023	
APPRVD	Frank Stanton	06/12/2023	
STATUS	Released		

HMHDB400 / S / SFM45 / 72

017757

A1 1/4

A

REVISION HISTORY			
REVISION	CHANGE	DATE	APPROVED
A		06/12/2023	Frank Stanton

! RETURN LINE PRESSURE MUST EXCEED CASE DRAIN PRESSURE AT ALL TIMES

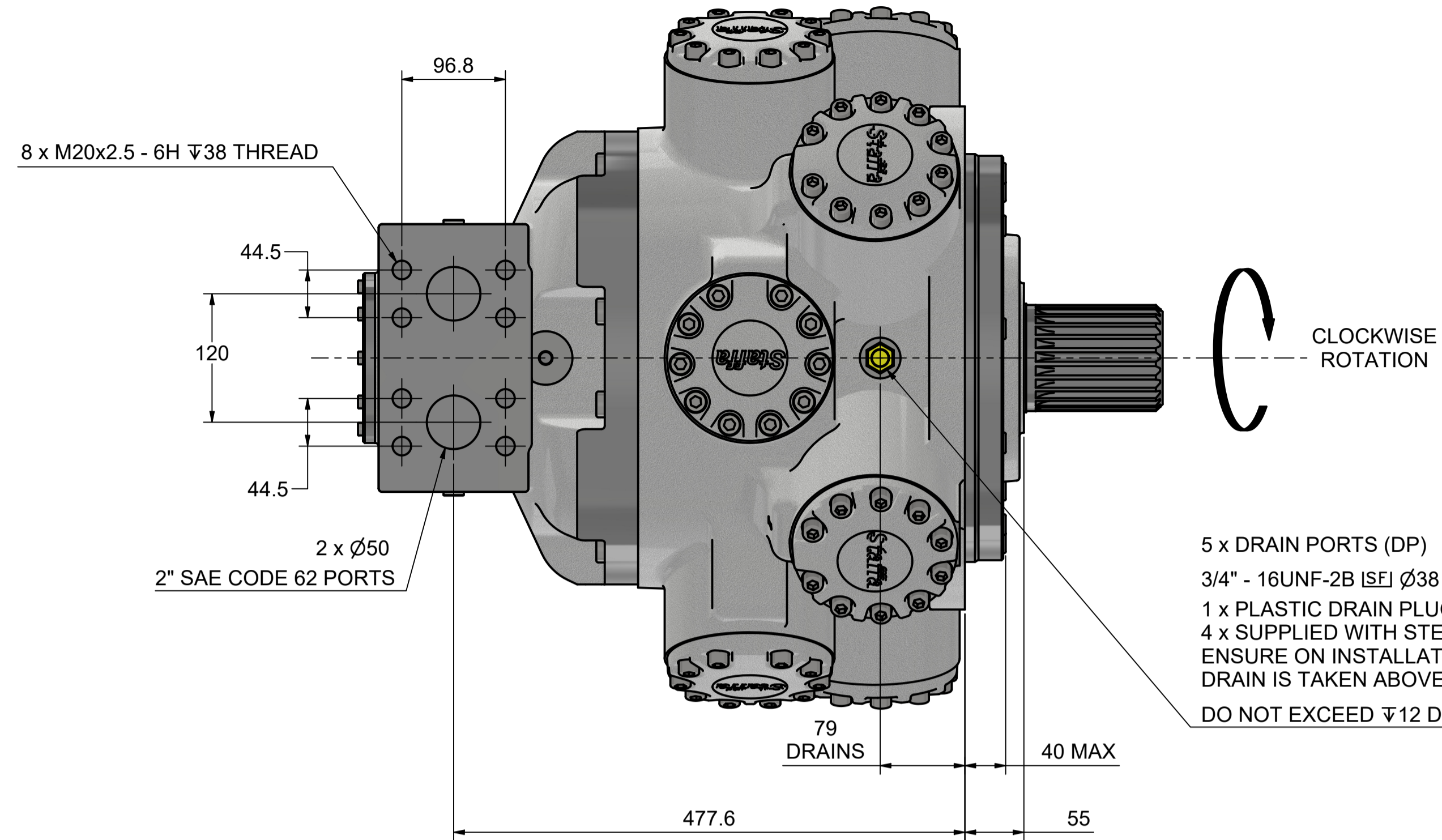
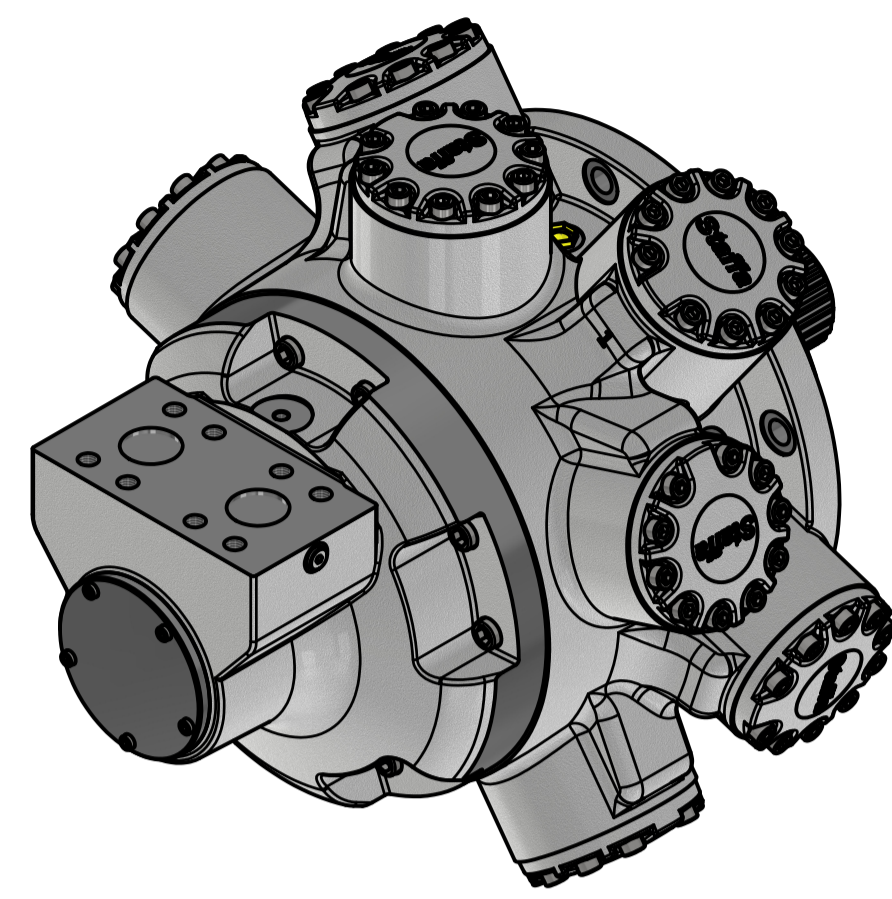

DIN5480 W100 x 4 x 24 - 7h		
Number of Teeth	<i>z</i>	24
Module	<i>m</i>	4
Pressure Angle	<i>α</i>	30
Tip Circle Diameter	<i>d_{a1}</i>	91.2-0.4
Root Form Circle Diameter	<i>d_{Fr1}</i>	91.92 max
Root Circle Diameter	<i>d_{r1}</i>	99.2 h11
Maximum Effective Tooth Thickness	<i>S_{vm}max</i>	6.052
Actual Maximum ref. Tooth Thickness	<i>S_{max}</i>	6.036
Actual Minimum Tooth Thickness	<i>S_{min}</i>	6.012
Measuring Circle Diameter	<i>D_M</i>	8.0
Max. ref. dim. Over Measuring Circles	<i>M_{1max}Ref.</i>	108.412
Min. Dimension Over Measuring Circles	<i>M_{1min}</i>	108.373

CLOCKWISE ROTATION

5 x DRAIN PORTS (DP)
 3/4" - 16UNF-2B ISEI ∅38
 1 x PLASTIC DRAIN PLUG (POSITION DP1)
 4 x SUPPLIED WITH STEEL PLUG (POSITIONS DP2 DP3 DP4 DP5)
 ENSURE ON INSTALLATION DRAIN IS TAKEN ABOVE MOTOR CENTRELINE
 DO NOT EXCEED ∇12 DRAIN PORT

REVERSE PORT CONNECTIONS FOR OPPOSITE DIRECTION OF SHAFT ROTATION

FLOW DIRECTION

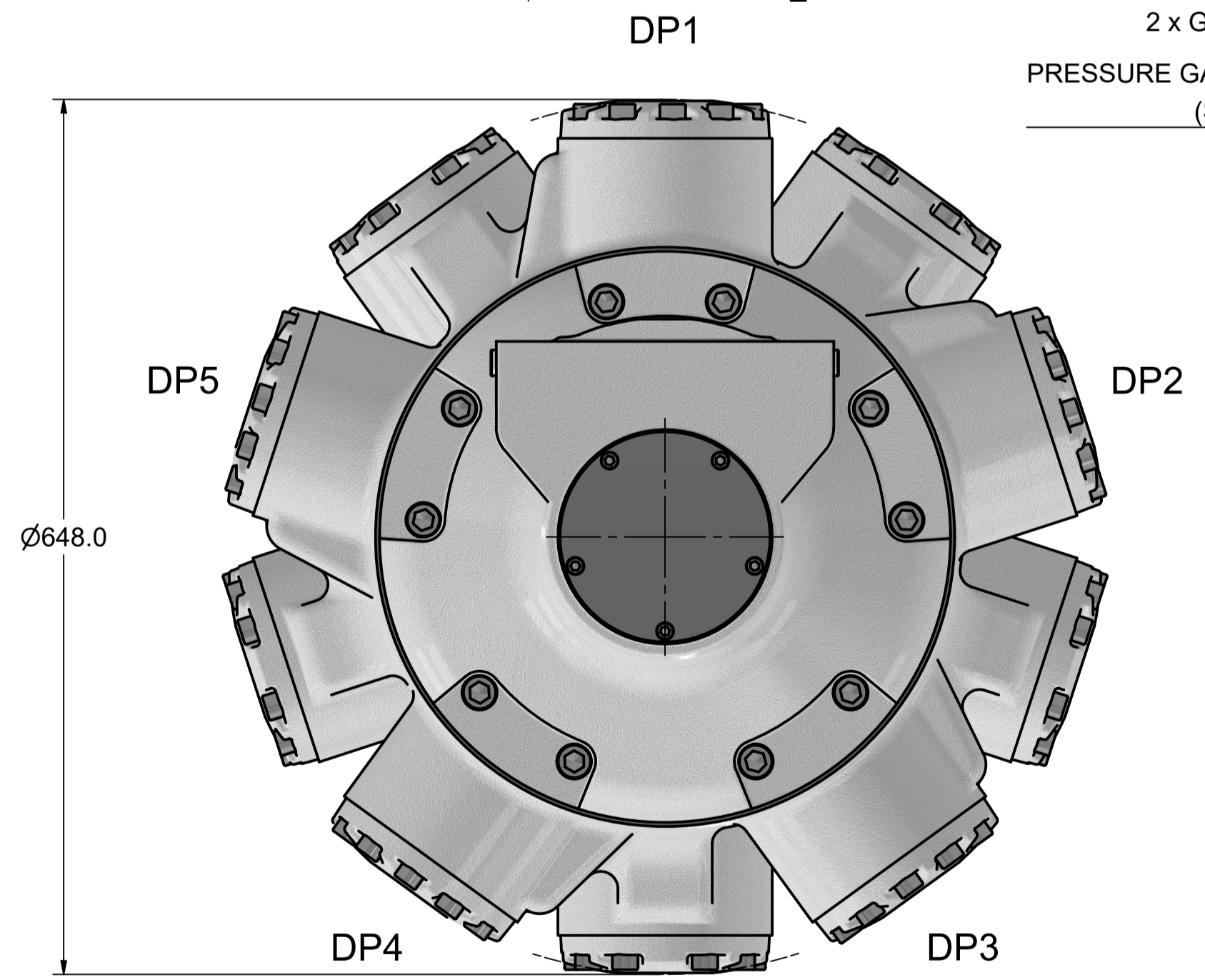

2 x G1/4" (BSPP) ISEI ∅25.4
 PRESSURE GAUGE TAPPING ∇15.5
 (SUPPLIED PLUGGED)

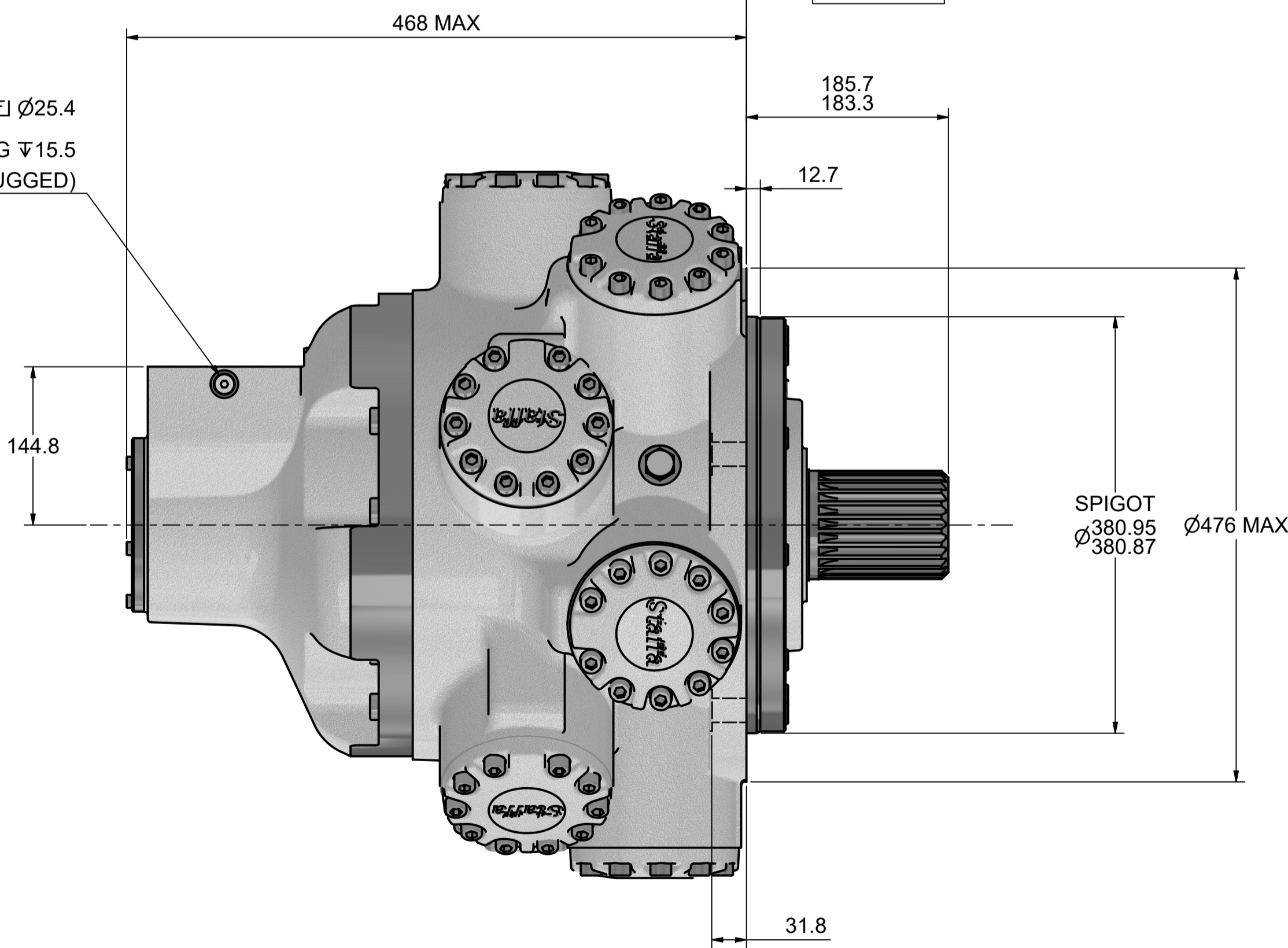

∅0.15

5x ∅22 MOUNT HOLES ISEI∅38

∅419.1

3/4-16 UNF - 2B ∇31.8
 ∇∅22.2 X 60°

DISPLACEMENT	cc/rev	6800
SPECIFIC RUNNING TORQUE	Nm/bar	101
MAX CONTINUOUS SPEED	RPM	120
MAX CONTINUOUS POWER	kW	190
MAX CONTINUOUS PRESSURE	bar	250
MAX INTERMITTENT PRESSURE	bar	300
APPROXIMATE MASS	kg	510

<small>ALL TECHNICAL DATA DISCLOSED HEREIN IS THE PROPERTY OF KAWASAKI AND SHALL NOT BE USED BY OTHERS FOR MANUFACTURE, PROCUREMENT OR DISCLOSURE WITHOUT THE WRITTEN PERMISSION OF THE OWNER.</small>	NAME	DATE	
	Christian Callanga	06/12/2023	
	CHKD	DATE	HMHDB400 / Z / SFM45 / 72
	Frank Stanton	06/12/2023	
APPRVD	DATE	017757	
Frank Stanton	06/12/2023		
STATUS	Released		A
PRINT SIZE	A1	SHEET 2/4	

